



Safe Link CB

SF₆ insulated Ring Main Unit for secondary distribution

- SF₆ gas insulated switchgear with extremely compact and robust design
- 12 kV, 630 A, 21 kA for 3 sec; metal enclosed design with IP5 4 degree of protection, suitable for outdoor conditions
- Fully extensible with option of adding standalone vacuum circuit breakers or ring switches
- Internal arc classified and fully type tested according to latest IEC standards
- Robotically welded stainless steel tank
- Recyclable and very low environmental impact
- Vacuum circuit breaker with high mechanical endurance of 5000 operations
- Maintenance-free and complete safety for user and pedestrian with no exposure to live parts
- All in-built mandatory safety interlocks provided to ensure operator safety
- Manufactured according to ISO 9001 14001 and OHSAS 18001
- Complete solutions including applications for remote control and monitoring

Technical data

		C Module		V Module	
		Switch disconnector	Earthing Switch	Vacuum circuit Breaker	Earthing switch/ Disconnector
Rated voltage	KV	12	12	12	12
Power frequency withstand voltage	KV	38	38	38	38
- across disconnector	KV	45	45	45	45
Lightning impulse withstand voltage	KV	95	95	95	95
- across disconnector	KV	110	110	110	110
Related normal current	A	630	630	630	630
Breaking capacities					
- active load breaking current	A	630			
- closed loop breaking current	A	630			
- cable charging breaking current	A	25		25 (Class C2)	
- earth fault breaking current	A	75			
- earth fault cable and line charging	A	43.5			
- short circuit breaking current	KA			21	
Making capacity	KA	52.5	52.5	52.5	See ¹⁾
Short time current (3-sec)	KA	21	21	21	21
Mechanical Operations	nos	M1	M0	M1+ 3000	M0

1) Disconnector manually operated, earthing operation is through Vacuum B K R. Hence no making capacity assigned

Internal Arc Classification (IAC)

IAC -(20kA for 1 sec)

IKEJA	VICTORIA ISLAND	APAPA	PORT HARCOURT	KANO	IBADAN
T: +234 814 011 1111	T: +234 814 022 2222	T: +234 814 033 3333	T: +234 814 044 4444	T: +234 814 055 55555	T: +234 814 066 6666
jb.ikeja@jubailibros.com	jb.vi@jubailibros.com	jb.apapa@jubailibros.com	jb.phc@jubailibros.com	jb.kano@jubailibros.com	jb.ibadan@jubailibros.com

Various Configurations

+CVC+

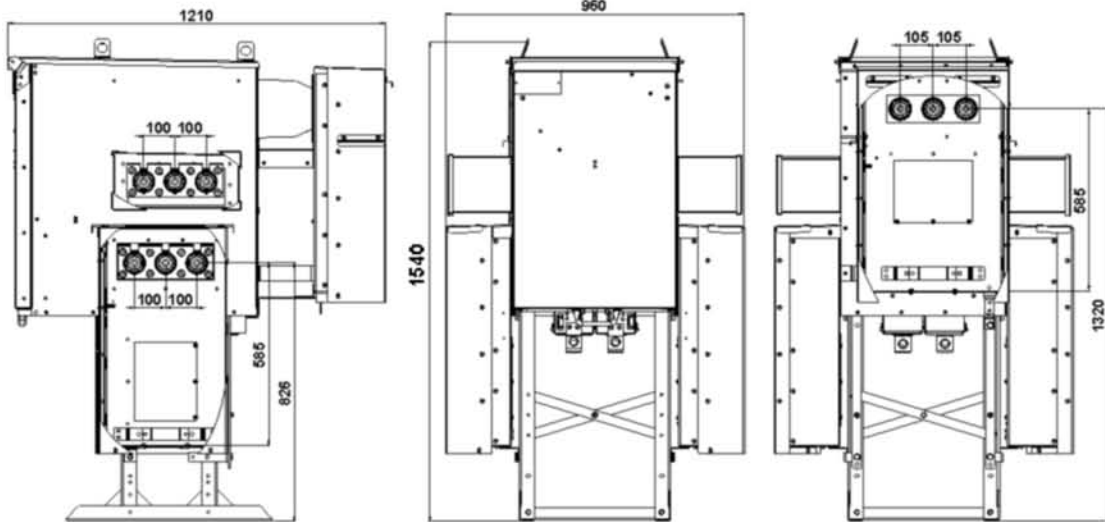

+V+

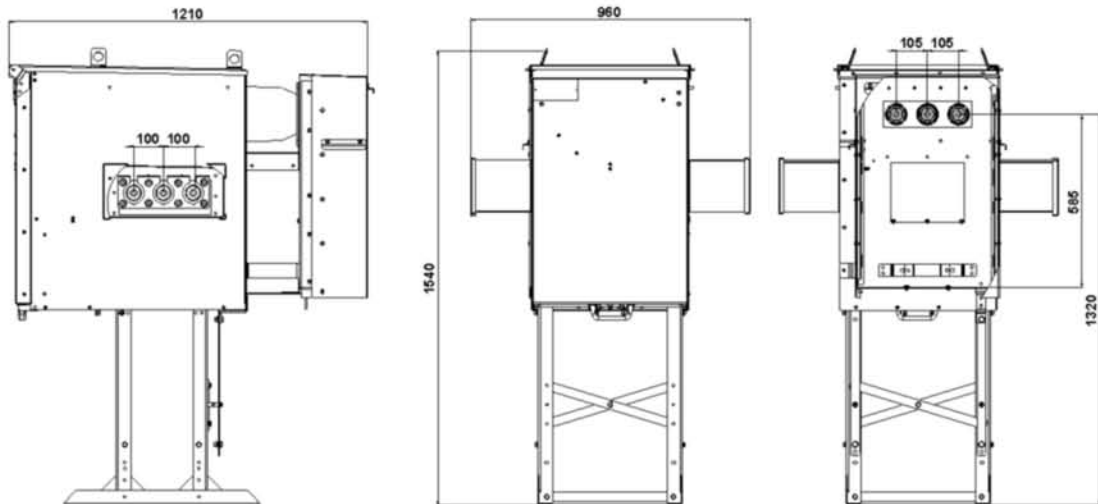

CV+ / +CV+

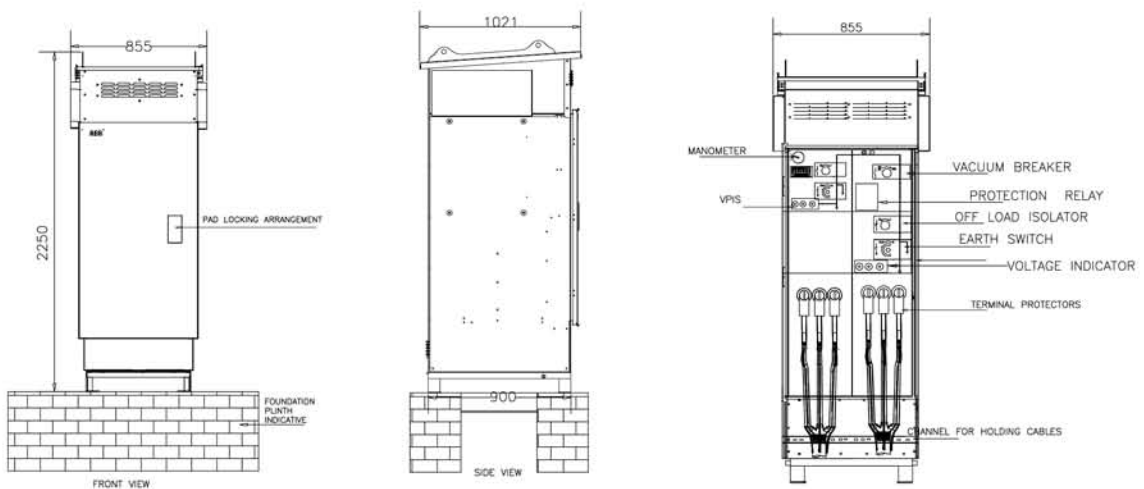

IKEJA

VICTORIA ISLAND

APAPA

PORT HARCOURT

KANO

IBADAN

T: +234 814 011 1111

T: +234 814 022 2222

T: +234 814 033 3333

T: +234 814 044 4444

T: +234 814 055 5555

T: +234 814 066 6666

jb.ikeja@jubailibros.com

jb.vi@jubailibros.com

jb.apapa@jubailibros.com

jb.phc@jubailibros.com

jb.kano@jubailibros.com

jb.ibadan@jubailibros.com